

advanced FLOW engineering

Instruction Manual P/N: 51-76003-R

Make: **Toyota** Model: **Tundra** Year: **2007-2021** Engine: **V8-5.7L**



- Please read the entire instruction manual before proceeding.
- Ensure all components listed are present.
- If you are missing any of the components, call customer support at 951-493-7185.
- Ensure you have all necessary tools before proceeding.
- Do not attempt to work on your vehicle when the engine is hot.

Retain factory parts for future use.

Label	Qty.	Description	Part Number
A	1	Air Filter (Pro DRY S)	21-91072
B	1	Tube	05-76003R1
C	1	Housing	05-76003R2
D	2	Clamp, 56 (3-1/16"-4")	03-50009
E	1	Clamp, T-Bolt (8-5/16"-8-5/8") SS	03-50267
F	1	Coupling, Sili Straight: 3-1/2" ID x 2" L	05-01280
G	2	Screw, Torx Hd M4 x .7x8	05-50491
H	1	Fitting, Hose 3/16" ID x 1/8 npt	03-50191
I	1	Hose, 1/2 ID Black (18"L)	05-00027
J	1	Plug	05-01429

Tools needed:

8mm Nut driver, 10 mm Nut driver, Standard pliers or channel locks, Phillips head screwdriver, Flat head screw driver, 1/4" ratchet, 10mm socket.

Note:

This intake system is not CARB exempt at this time and is not legal for sale in California or use on vehicles registered with the California Department of Motor Vehicles.

NOTE: All Installation photos are of the black version of this kit. All steps are the same.

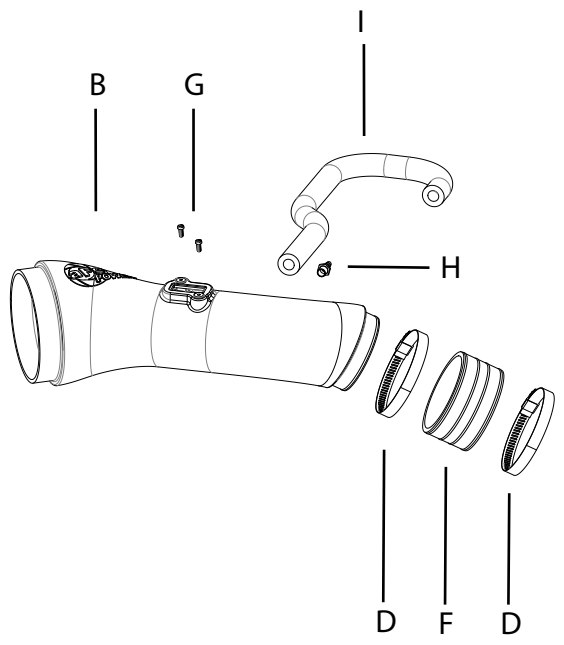
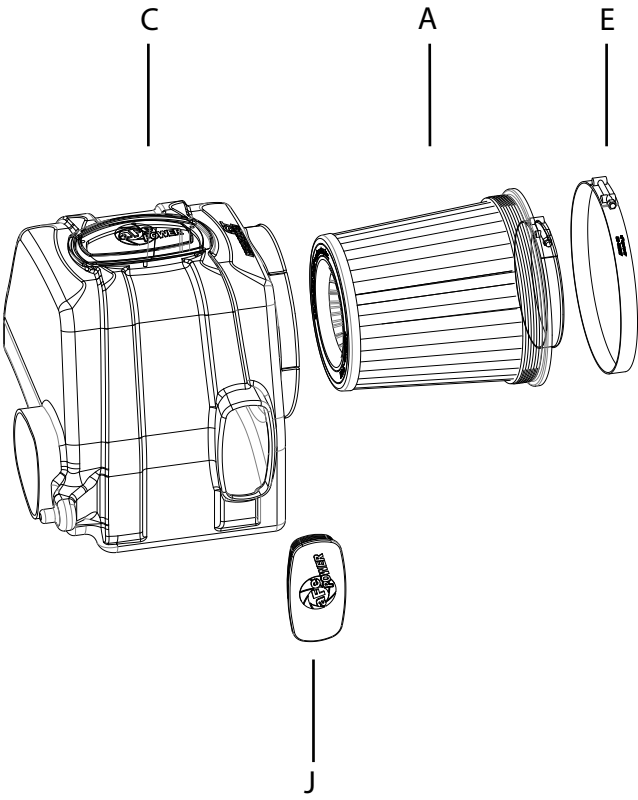



Figure A

Refer to Figure A for Step 1

Step 1: Remove engine cover by grasping sides and carefully lifting up.



Refer to Figure B for Step 2

Step 2: Unclip the wire harness tab from the factory airbox.



Figure C

Refer to Figure C for Steps 3-8

Step 3: Disconnect the mass air flow (MAF) sensor harness (1).

Step 4: Disconnect the vacuum line (smaller tube) from the intake factory tube (2).

Step 5: Remove the crank case vent (CCV) hose. *Optional: save the 2 factory spring clips for use later (3).

Step 6: With 10mm nut driver, loosen both bolts securing the housing to the fender well (4).

Step 7: With 10mm nut driver, loosen hose clamp on throttle body (5).

Step 8: Lift and remove factory intake system out of vehicle.



Figure D

Refer to Figure D for Steps 9-10

Step 9: Using a Phillips head screwdriver, remove the MAF sensor and transfer to the aFe intake tube.

Secure using the two provided flat head screws.

Step 10: Install brass hose fitting on aFe intake tube and tighten.



Figure E

Refer to Figure E for Step 11

Step 11: Remove and transfer the two rubber isolation mounts, and the large rubber grommet to aFe Momentum housing (6).



Figure F

Refer to Figure F for Step 12

Step 12: Before installing housing, insert the captive bolts into the rubber grommets from the inside as shown.



Figure G

Refer to Figure G for Steps 13-14

Step 13: Install aFe Momentum housing as shown. Tighten bolts on inside of housing using ¼" ratchet with 10mm socket. Do not over tighten.

Step 14: Install large t-bolt clamp as shown but do not tighten at this time.



Figure H

Refer to Figure H for Steps 15-17

Step 15: Install air filter into housing and tighten large t-bolt clamp (7).

Step 16: Slide smaller t-bolt clamp over filter flange as shown but do not tighten yet (8).

Step 17: Slide straight coupling over throttle body along with both band clamps as shown. Do not tighten band clamps yet (9).



Figure I

Refer to Figure I for Step 18

Step 18: Insert aFe tube into Momentum filter as shown and rotate forward to line up with throttle body.

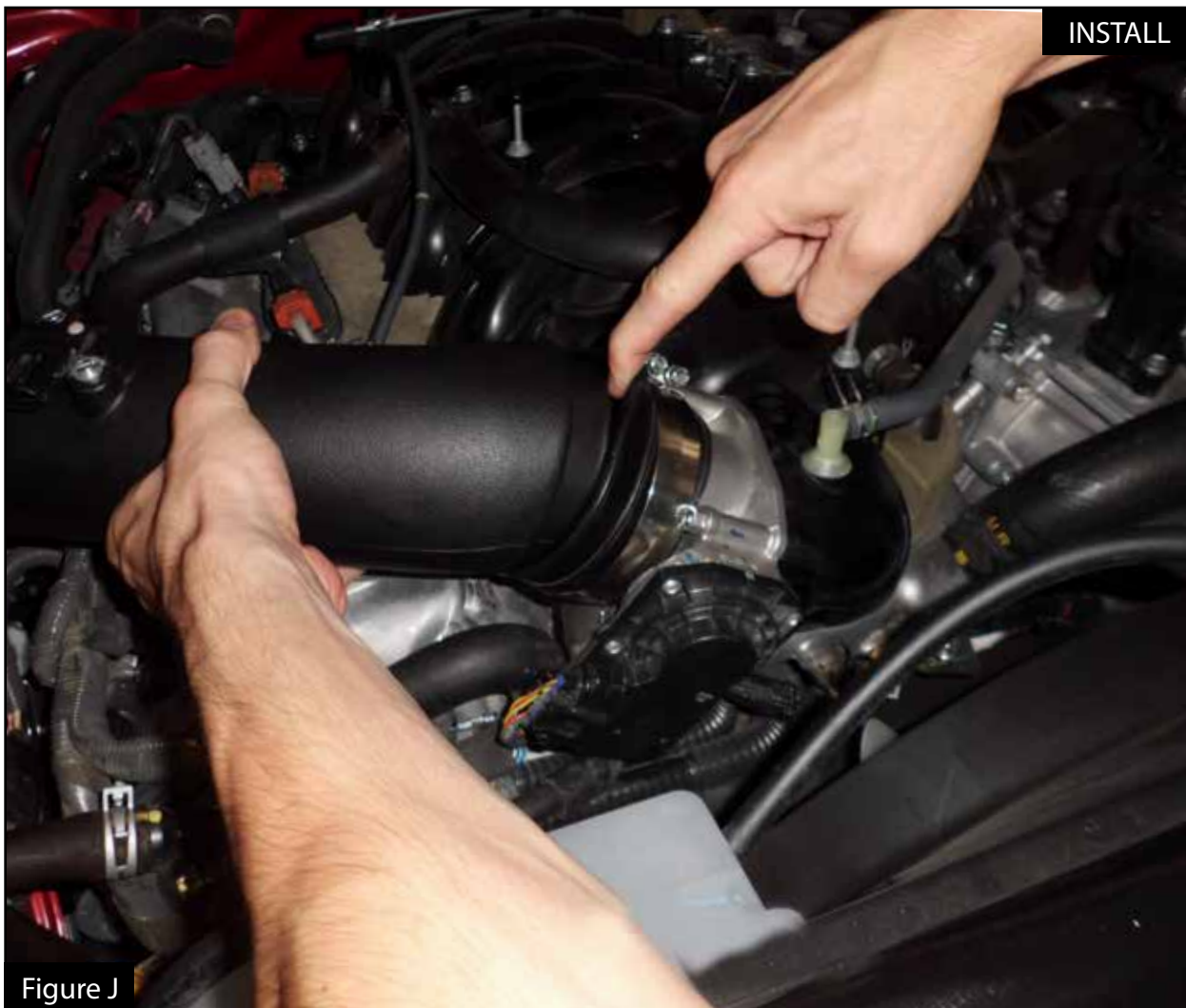

Figure J

Refer to Figure J for Steps 19-20

Step 19: With both band clamps loose, insert a Fe tube into straight coupling as shown.

Step 20: Tighten both band clamps on throttle body and small t-bolt clamp on filter at this time.



Figure K

Refer to Figure K for Steps 21-23

Step 21: Slip metal hose clips over provided hose and install as shown (10).

Step 22: Reconnect vacuum line to brass fitting on the aFe tube (11).

Step 23: Reconnect MAF sensor as shown (12).



Figure L

Refer to Figure L for Steps 24-25

Step 24: Reinstall engine cover. Your installation is now complete!

Step 25: (Optional) install plug on side of housing.

*Verify all connections are secure 100-200 miles after installation



advanced FLOW engineering, inc.

Corona, CA 92879

<https://afepower.com/contact>