

advanced FLOW engineering

Cold Air Intake System

Instruction Manual P/N: 56-70058D / 56-70058R

Make: Hyundai

Model: Kona N

Year: 2022-2023

Engine: L4-2.0L(t)



- Please read the entire instruction manual before proceeding.
- Ensure all components listed are present.
- If you are missing any of the components, call customer support at 951-493-7185.
- Ensure you have all necessary tools before proceeding.
- Do not attempt to work on your vehicle when the engine is hot.
- Retain factory parts for future use.

Label	Qty.	Description	Part Number
A	1	Air Filter (Pro 5R) For 56-70058R	24-91144
A	1	Air Filter (Pro DRY S) For 56-70058D	21-91144
B	1	Tube	05-5670058B1
C	1	Housing	05-5670058B2
D	1	Coupling, Silicone Reducer: (2-1/2" x 3") ID x 3'L	05-01736
E	1	Plug, Air Box	05-01527
F	1	Clamp, #048 (2-9/16" - 3-1/2 ")	03-50007
G	1	Clamp, #044 (2-5/16" - 3-1/4")	03-50019
H	1	Fitting, Aluminum 11mm	03-50615
J	1	Fitting, Aluminum 10mm	03-50641
K	2	Push Clip	03-50616

Installation will require the following tools:

Socket set, extension, ratchet, adjustable wrench, pliers, and a flat-head screwdriver

Warranty Information available at: <https://afepower.com/contact#warranty>

Emissions Disclaimer: This product is not currently CARB exempt and is not available for purchase in California or for use on any vehicle registered with the California Department of Motor Vehicles.

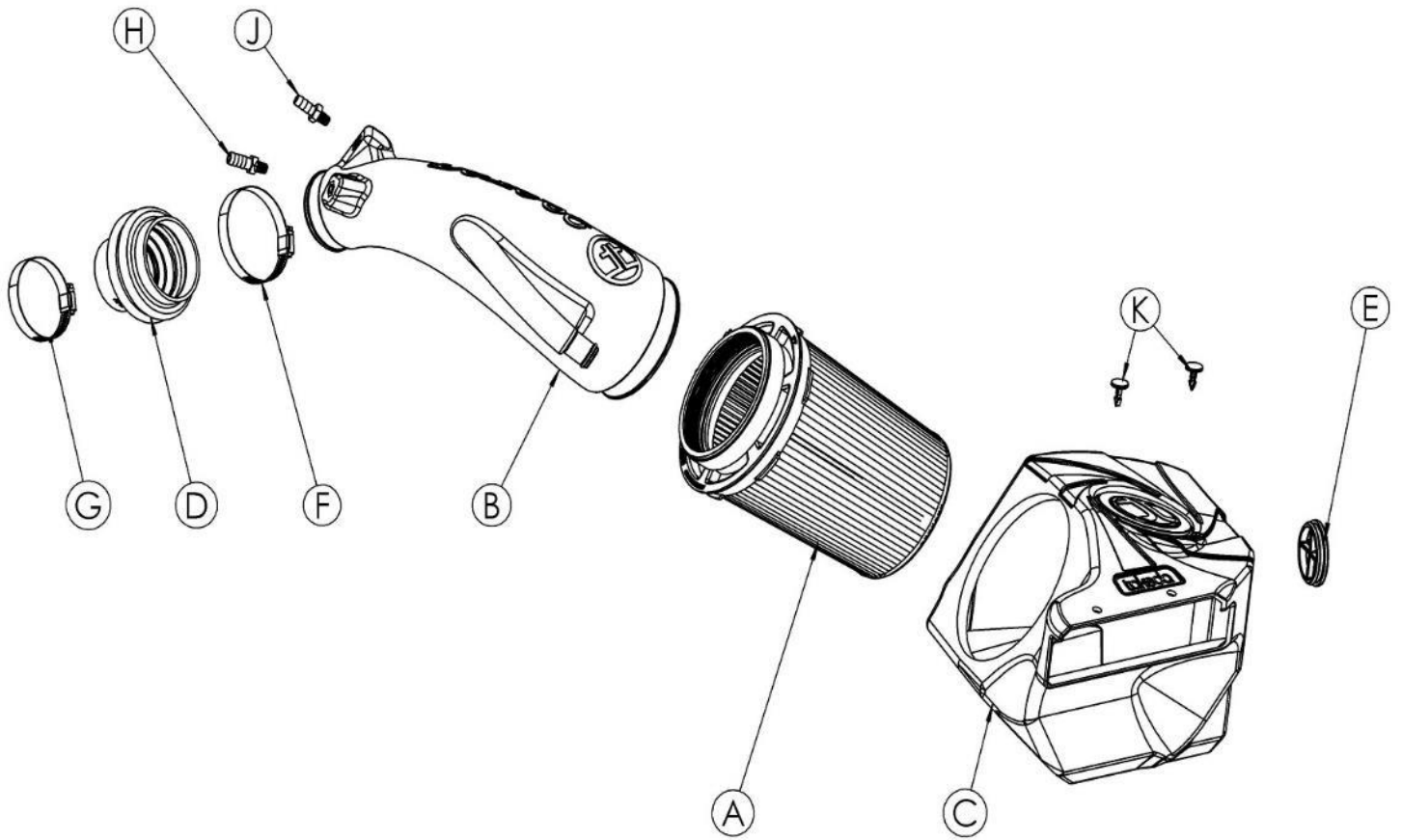

**Figure A****Refer to Figure A for Steps 1-2**

Step 1: Using pliers, open the clamp securing the larger hose to the air intake tube, then slide the clamp away from the intake tube. This clamp will be re-used. Disconnect the rubber hose from the air intake tube.

Step 2: Using pliers, open the clamps securing the smaller hoses to the air intake tube, then slide the clamp away from the intake tube. These clamps will be re-used. Disconnect the rubber hoses from the air intake tube.



Figure B

Refer to Figure B for Step 3

Step 3: Loosen the clamp at the turbo inlet.



Figure C

Refer to Figure C for Step 4

Step 4: Loosen the three bolts securing the factory housing to the vehicle. Two (2) of these three bolts will be re-used during the installation of the Takeda air intake system.



Figure D

Refer to Figure D for Steps 5-6

Step 5: Remove the two (2) push clips connecting the factory air scoop to the front of the car.

Step 6: Remove the housing and air inlet as one piece out of the vehicle.



Figure E

Refer to Figure E for Step 7

Step 7: Transfer the factory grommets and sleeves from the factory housing onto the Takeda housing.



Figure F

Refer to Figure F for Steps 8-9

Step 8: Install the Takeda housing into the engine bay.

Step 9: Secure the housing with the two (2) factory bolts removed in **Step 4**. The bolts will be installed inside of the Takeda housing.

**Smaller fitting
(With three ribs)**



**Bigger fitting
(With four ribs)**

Figure G

Refer to Figure G for Step 10

Step 10: Using a 16mm wrench, install the aluminum fittings into the Takeda air intake tube. The two fittings are different. The bigger one (with four ribs) goes on the side of the tube. The smaller one (with three ribs) goes on the top of the tube.

Note: This is an NPT fitting, the small gap between the 16mm hex and the tube is normal.

**Figure H****Refer to Figure H for Step 11**

Step 11: Install the coupling onto the turbo inlet (the smaller end of the coupling goes onto the turbo inlet).
Install the provided clamps over the coupling and only tighten the turbo inlet side.

**Figure I****Refer to Figure I for Steps 12-13**

Step 12: Install the supplied air filter into the Takeda housing by firmly pushing it into the housing until the filter tabs lock into place. Install the clamp onto the filter, but do not tighten at this time.

Step 13: Next secure the housing to the air inlet with the two provided push clips.

**Figure J****Refer to Figure J for Steps 14-16**

- Step 14: Slip the Takeda intake tube into the air filter and coupling. Align the tube, filter and coupling, then tighten all clamps.
- Step 15: Connect the small rubber hoses to the aluminum fittings on the tube. Secure them with the factory spring clamps.
- Step 16: Connect the bigger rubber hose to the Takeda air intake tube. Secure it with the factory spring clamp.

**Figure K****Refer to Figure K for Step 17**

Step 17: The kit includes an optional plug to close off the side auxiliary air inlet. Install the plug if you wish to close off the side auxiliary air inlet and only capture cold air from the front.

- Without the plug installed, the Takeda intake will capture the maximum air available. More airflow offers more power, yet some of this air is picked up from inside the engine compartment and could be warmer air. Warmer air will affect the performance of the vehicle.
- The plug installed on the housing will block off any hot engine air entering the housing and make sure only the coolest air available is directed into the engine. It will also reduce the noise of the intake.



Figure L

Refer to Figure L for Step 18

Step 18: Make sure that all clamps and connections are secured. Your installation is now complete. Thank you for choosing Takeda USA!

NOTE: Check to ensure that all screws, clamps, and connectors are secure after 100-200 miles.



advanced FLOW engineering, inc.

252 Granite Street Corona, CA 92879

<https://afepower.com/contact>