



INSTALLATION INSTRUCTIONS

Cat-Back Exhaust

MAKE: Toyota
 MODEL: Tundra
 YEAR: 2022-2023
 ENGINE: V6-3.5L

49-36061-B/P

**NOTE: Fits CrewMax 5.5ft (145.7" WB)/6.5ft (157.7" WB),
 And Double Cab 8.1ft (164.6" WB)/6.5ft (145.7" WB)**

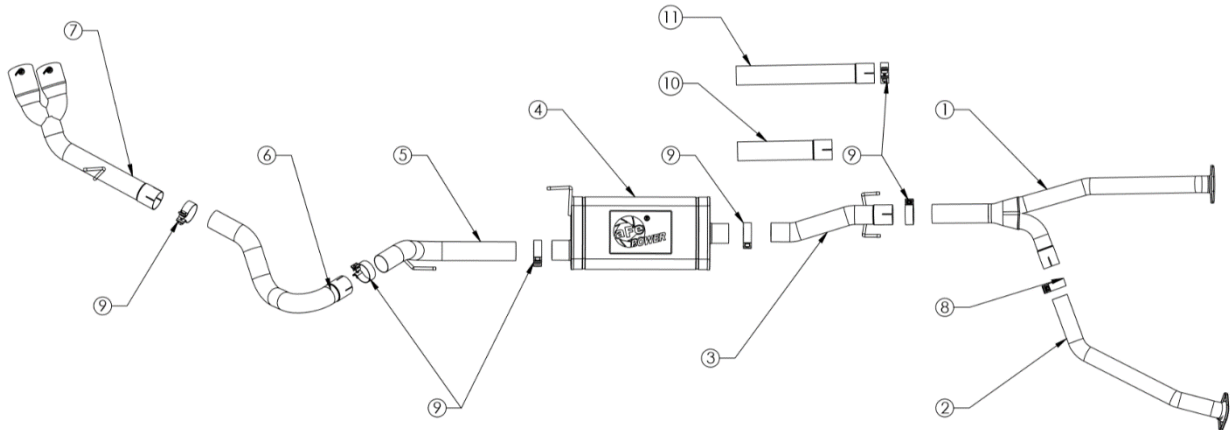

Item	Description	Part Number	Quantity
1	Driver Side Front Pipe Assembly	05-245338	1
2	Passenger Side Front Pipe Assembly	05-245339	1
3	Mid-Pipe Assembly	05-245340	1
4	Muffler Assembly	05-245341	1
5	Muffler Outlet Pipe Assembly	05-245342	1
6	Over-Axle Pipe Assembly	05-245343	1
7	Tail-Pipe Assembly Black Tip	05-245344B	1
7	Tail-Pipe Assembly Polished Tip	05-245344	1
8	Clamp, Band: 2-1/2"	05-41061	1
9	Clamp, Band: 3"	05-41055	6
10	Extension Pipe #1	05-245082	1
11	Extension Pipe #2	05-245083	1

aFe POWER recommends professional installation on this product. Thoroughly inspect the aFe POWER exhaust system to make sure there is no damage from shipping (if damage is noted, immediately contact aFe POWER customer service). Allow time for your vehicle to cool down prior to installation. When working on your vehicle proceed with caution. Wear protective safety equipment; eye goggles and gloves to ensure a safe installation.

Install band clamps to proper torque specifications of 40-45 ft-lb.

Install V-band clamps with anti-seize lubricant and hand tighten only to torque specifications of 10-15 ft-lb.





INSTALLATION INSTRUCTIONS

Cat-Back Exhaust

MAKE: Toyota

49-36061-B/P

MODEL: Tundra

YEAR: 2022

**NOTE: Fits CrewMax 5.5ft (145.7" WB)/6.5ft (157.7" WB),
And Double Cab 8.1ft (164.6" WB)/6.5ft (145.7")**

ENGINE: V6-3.5L

1. **(Read instructions prior to installation.)** It is recommended to not fully tighten the exhaust until it has been fully installed. Leave loose for adjustability.
2. Secure vehicle on jack stands (refer to your manual for specified jack stand positions).
3. For faster installation, spread out the parts of the exhaust alongside your vehicle as shown in the diagram above.
NOTE: Without a vehicle lift, it may be necessary to cut the OE exhaust to remove it from the vehicle.
4. Lower the spare tire to allow for clearance for exhaust removal.
5. Lift the vehicle and secure on a vehicle lift or jack stands.
6. Lower the rear vehicle axle to the limits of its suspension travel. This will allow for removal the OE exhaust without cutting.
7. Secure the stock exhaust with jack/stands.
8. Remove the bolts and springs at the front of the vehicle's exhaust. Retain the hardware, it will be re-used for installation of the aFe POWER exhaust.
9. Remove the OE exhaust hangers from the isolators. Be careful to not damage the isolators.
10. Lower the front of the exhaust, and then snake the exhaust around the rear axle and remove it from the vehicle.
11. Install the passenger side front pipe assembly onto the driver side front pipe assembly using the supplied 2-1/2" band clamp. Do not fully tighten bank clamp to allow for adjustment.
12. Install the front pipe assembly onto the catalytic converters using the springs and bolts removed in step 8.
13. Use table below for guide on extension pipes and install the extension pipe to the front pipe assembly (if needed) with the supplied 3" band clamp.

Cab Configuration	Bed Configuration	Wheelbase	Extension Pipe?
Double Cab	6.5 ft Standard Bed	145.7"	NO
Double Cab	8.1 ft Long Bed	164.6"	YES (22" Extension Pipe)
CrewMax	5.5 ft Short Bed	145.7"	NO
CrewMax	6.5 ft Standard Bed	157.7"	YES (15" Extension Pipe)

14. Install the mid-pipe assembly onto the front pipe assembly or extension pipe using the supplied 3" band clamp. Install the hangers of the mid-pipe onto the vehicle's isolation mounts.
15. Install the muffler assembly with the supplied 3" band clamp and install the hanger into the vehicle's isolator mount.
16. Install the muffler outlet pipe assembly with the supplied 3" band clamp and install the hanger into the vehicle's isolator mount.
17. Install the over-axle pipe with the supplied 3" band clamp.
18. Install the tail-pipe assembly with the supplied 3" band clamp and install the hanger into the vehicle's isolator mount.
19. Ensure that all the components of the aFe POWER exhaust system are aligned and are at a safe clearance from all wires, hoses, brake lines, body parts, and tires.
20. Start from the front of the aFe exhaust system and evenly tighten all clamps and fasteners.
21. Start the vehicle and check for any leaks. If any leaks are found, determine cause and repair as necessary.
22. Lower the vehicle back to the ground and secure the spare tire.
23. It is recommended to re-tighten all clamps and hardware after 50-100 miles.