



INSTALLATION INSTRUCTIONS

Axle-Back Exhaust

MAKE: Lexus
MODEL: IS250/350
YEAR: 2006-2013
ENGINE: V6-2.5L/V6-3.5L (FWD)

49-36055-B
49-36055-C
49-36055-L
49-36055-P

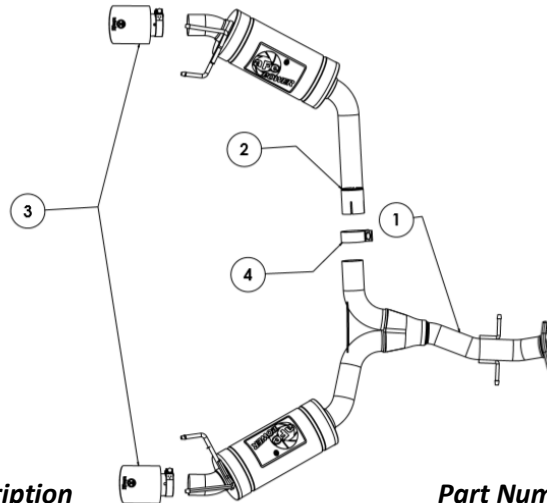

Item	Description	Part Number	Quantity
1	Passenger Side Muffler Assembly	05-245181	1
2	Driver Side Muffler Assembly	05-245182	1
3	EXH Tip 2-1/2 In x 4-1/2 Out x 7L Bolt-On Blk	49T25454-B07	2
3	EXH Tip 2-1/2 In x 4-1/2 Out x 7L Bolt-On CF	49T25454-C07	2
3	EXH Tip 2-1/2 In x 4-1/2 Out x 7L Bolt-On Blue	49T25454-L07	2
3	EXH Tip 2-1/2 In x 4-1/2 Out x 7L Bolt-On Pol	49T25454-P07	2
4	Clamp, Band: 2-1/2"	05-41061	1

aFe POWER recommends professional installation on this product. Thoroughly inspect the aFe POWER exhaust system to make sure there is no damage from shipping (if damage is noted, immediately contact aFe POWER customer service). Allow time for your vehicle to cool down prior to installation. When working on your vehicle proceed with caution. Wear protective safety equipment; eye goggles and gloves to ensure a safe installation.

Install band clamps to proper torque specifications of 40-45 ft-lb.





INSTALLATION INSTRUCTIONS

Axle-Back Exhaust

MAKE:	Lexus	49-36055-B
MODEL:	IS250/350	49-36055-C
YEAR:	2006-2013	49-36055-L
ENGINE:	V6-2.5L/V6-3.5L (FWD)	49-36055-P

1. **(Read instructions prior to installation.)** It is recommended to not fully tighten the exhaust until it has been fully installed. Leave loose for adjustability.
2. Secure vehicle on jack stands (refer to your manual for specified jack stand positions).
3. For faster installation, spread out the parts of the exhaust alongside your vehicle as shown in the diagram above.
4. Secure the stock exhaust with jack/stands.
5. Remove the 2 spring bolts on the OE exhaust system.
6. Remove the OE exhaust system off the rubber isolation mounts.
7. Install TAKEDA Passenger Side Muffler Assembly using OE hardware and insert the hanger rod into the OE isolation mount.
8. Install TAKEDA Driver Side Muffler Assembly onto TAKEDA Passenger Side Muffler Assembly using the provided 2-1/2" band clamp and insert the hanger rod into the OE isolation mount.
9. Install TAKEDA clamp on tips.
10. Ensure that all the components of the TAKEDA exhaust system are aligned and are at a safe clearance from all wires, hoses, brake lines, body parts, and tires.
11. Start from the front of the TAKEDA exhaust system and evenly tighten all clamps and fasteners.
12. Start the vehicle and check for any leaks. If any leaks are found, determine cause and repair as necessary.
13. Remove vehicle from jacks stands.
14. It is recommended to re-tighten all clamps and hardware after 50-100 miles.