



INSTALLATION INSTRUCTIONS

Shorty Headers

MAKE: Ford
 MODEL: Mustang
 YEAR: 2011-2017
 ENGINE: V6-3.7L

48-43031
 48-43031-T

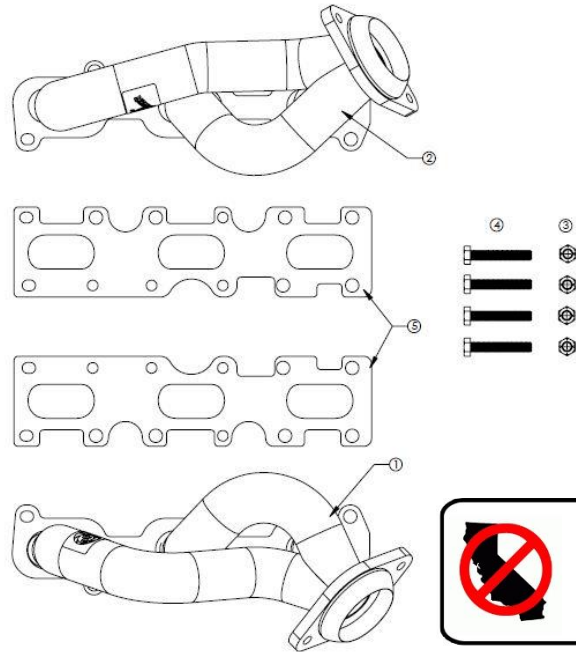



EMISSIONS DISCLAIMER
 This product is not currently CARB exempt and is not available for purchase in California or for use on any vehicle registered with the California Department of Motor Vehicles.

Item	Description	Part Number	Quantity
1	Driver Side Header Assembly	05-244053 05-244053T	1
2	Passenger Side Header Assembly	05-244052 05-244052T	1
3	M8 Nut	05-46057	4
4	M8 x 50mm Bolt	03-50476	4
5	Header Gasket	05-46489	2

aFe POWER recommends professional installation on this product. Thoroughly inspect the aFe POWER exhaust system to make sure there is no damage from shipping (if damage is noted, immediately contact aFe POWER customer service). Allow time for your vehicle to cool down prior to installation. When working on your vehicle proceed with caution. Wear protective safety equipment; eye goggles and gloves to ensure a safe installation.

Install band clamps to proper torque specifications of 40-45 ft-lb.

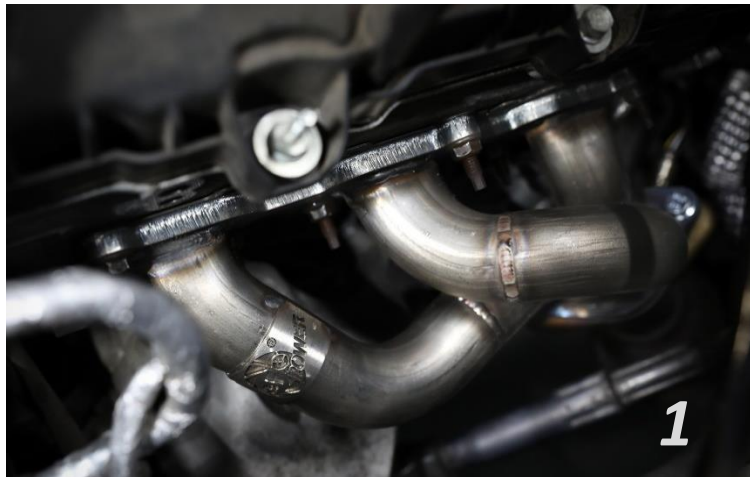



INSTALLATION INSTRUCTIONS

MAKE: Ford
MODEL: Mustang
YEAR: 2011-2017
ENGINE: V6-3.7L

Shorty Headers

48-43031

48-43031-T

1. **(Read instructions prior to installation.)** It is recommended to not fully tighten the headers until it has been fully installed. Leave loose for adjustability.
2. Secure vehicle on jack stands (refer to your manual for specified jack stand positions).
3. For faster installation, spread out the parts of the header alongside your vehicle as shown in the diagram above.
4. Secure the stock exhaust with jack/stands.
5. Disconnect the negative battery terminal.
6. Loosen the (x2) band clamps securing the stock exhaust to the connection pipes.
7. Remove the OE nuts from the heat shields.
8. Remove the driver side heat shield from exhaust manifold to gain access to exhaust manifold nuts.
9. Remove the (x2) nuts on each side of the factory connection pipe connecting to the exhaust manifolds. Support the factory connection pipes.
10. Remove the (x6) nuts securing driver side stock exhaust manifold to the cylinder head. Remove the stock exhaust manifold and stock gasket through hood of the vehicle. Repeat this process for the passenger side as well.
11. Locate the provided gasket onto the factory studs coming from the cylinder head and install driver side aFe POWER header using the factory nuts. Tighten nuts starting from center and working outward. Repeat process for the passenger side aFe POWER header.
12. Re-install the factory connection pipes with the provided hardware.
13. Ensure that all the components of the aFe POWER header are aligned and are at a safe clearance from all wires, hoses, brake lines, body parts, and tires.
14. Start from the front of the aFe POWER header and evenly tighten all clamps and fasteners.
15. Reconnect the battery.
16. Start the vehicle and check for any leaks. If any leaks are found, determine cause and repair as necessary.
17. Remove vehicle from jacks stands.
18. It is recommended to re-tighten all clamps and hardware after 50-100 miles.