

SWAY-A-WAY®

RACING TECHNOLOGY

252 Granite St, Corona, CA 92879
PH (844) 469-6827
aFeControl.com

2007-2018 Jeep Wrangler Rear Shock Installation

Parts List:

-2 Sway-A-Way Shocks - IFP (Internal Floating Piston) Piggyback reservoir or Bypass

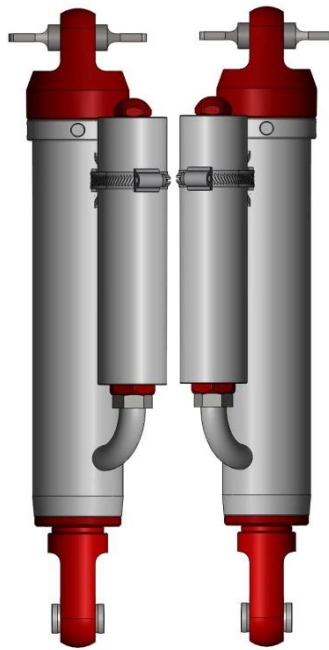
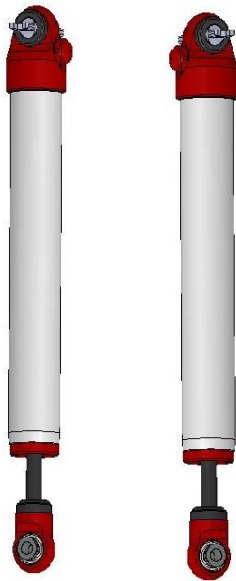

Driver

Passenger

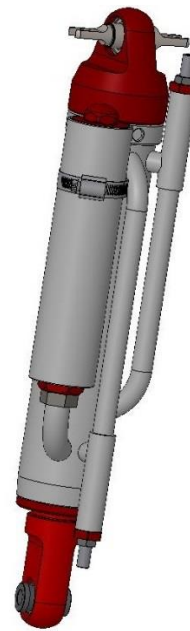

Driver

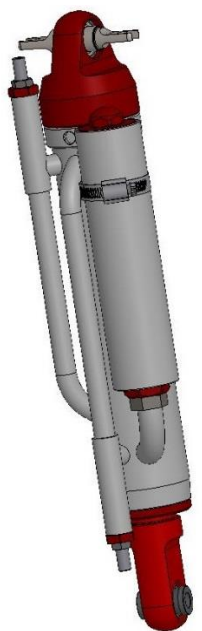

Passenger

Tool List

- 16mm socket with 6" ratchet extension
- 17mm socket
- 18mm wrench and socket
- 19mm socket
- Jack and jack stands
- Impact wrench (optional)
- Safety glasses

Removal and Installation Procedure for JK Rear

1. Park the vehicle on a level concrete surface where it is safe to work on your vehicle.
2. Lock and center the steering wheel.
3. Place blocks in front and behind the front tires so as to keep the vehicle from moving forwards or backwards.
4. Jack the car up under the rear differential and place safely on jack stands under the rear frame horns.
5. Use 19mm socket to remove lug nuts and wheels and lower jack to allow the rear end to droop.
6. Use 18mm socket and wrench to remove lower shock bolt.



7. Use 16mm socket with 6" ratchet extension to remove 2 upper bolts.
8. Remove old shock and install new shock.
9. Jack rear end up so the original bolt can pass through the lower mount and the rod end. Tighten using 18mm wrench and socket. (Bottom mount may need to be opened to accommodate spacers.) Also tighten the top bolts with the 17mm socket.



10. Piggyback Shocks should be oriented such that the reservoirs point inward.

****Bypass shocks will not clear the factory rear sway bar; it is recommended to replace it with an aftermarket sway bar that is mounted above the frame rails such as the Currie Anti-Rock****

11. Reinstall wheels and tighten lug nuts to factory spec.