

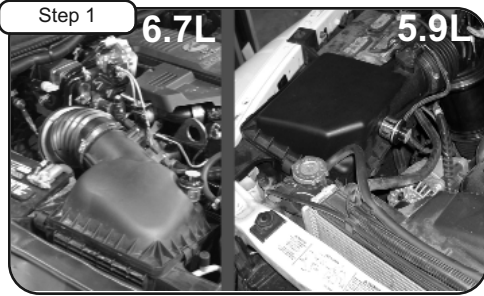

advanced FLOW engineering
252 Granite St.
Corona, CA 92878
Support: 951-493-7100
aFepower.com

Intake kit Installation Instructions: 2003-2009 Dodge Ram 2500-3500 Cummins (td) Stage-2 Air Intake

Kit P/N: 51/54/75-11342-1	Tools Required: 11mm socket or wrench 10mm socket or wrench 5/16" nut driver 1/4" nut driver Flat head screwdriver Ratchet w/ extension T-20 torx bit (included) Pliers/cutters	Parts list: 1 Air filter (P/N <i>Pro SR™</i> 24-91046 <i>ProDry-5™</i> 21-91046 or <i>Pro-GUARD 7™</i> 72-91046)(Step14) 1 Housing, wrinkle black(Step5) 1 Tube(Step7) 1 Coupler, straight hi-temp 4" x 2-1/2"(Step9) 1 3/4" trim seal @ 27.5"L(Step5) 1 3/4" trim seal @ 13.5"L(Step5) 2 Clamp, #064(Step5) 1 Torx bit, T-20(Step7) 1 Screw, hex M6 x 1 x 12(Step12) 1 Screw, hex M6 x 1 x 20(Step6) 3 Washer, flat(Step6&12)	1 Nut, hex M6(Step6) 1 Gasket, MAF sensor(Step7) 1 Gasket, temp sensor(Step7) 1 Bracket, "D" (Use only on 2003-2009)(Step4) 1 Bracket, 05-01114 (Use only on 2010)(Step4) 1 Plate, MAF sensor (for use of 5.9L)(Step7) 1 Grommet, rubber (for use of 5.9L)(Step7) 1 Plug, 05-01068 (for use of 5.9L)(Step7) 2 Screws, phillips #8-32 x 5/16"(Step7) 3 Screws, slotted #8-32 x 5/8"(Step8) 2 Screw, hex 3/8-16 x 1-1/2" (Step6) 2 Locknut, hex 3/8-16(Step6) 4 Washer, flat 3/8" x 7/8"OD(Step6)	
----------------------------------	----------------------------------------------------------------------------------------------------------------------------------------------------------------------------------------------------------------	------------------------------------------------------------------------------------------------------------------------------------------------------------------------------------------------------------------------------------------------------------------------------------------------------------------------------------------------------------------------------------------------------------------------------------------------------------------------	-------------------------------------------------------------------------------------------------------------------------------------------------------------------------------------------------------------------------------------------------------------------------------------------------------------------------------------------------------------------------------------------------------------------------------------------------------------------------------------------------------------------------------------	--



Step 1
Complete Stock Intake. Disconnect both negative battery cables.

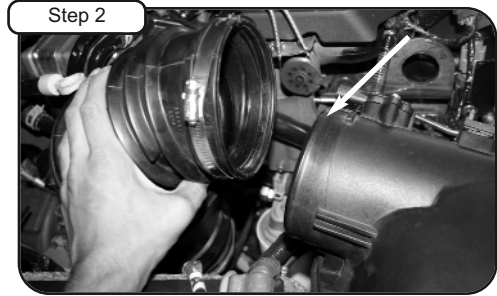

Step 2
With 5/16" nut driver loosen clamps on OE tube at turbo/air box and remove. (6.7L remove crank case line with pliers and save OE plastic fitting for later install)



Step 3
Disconnect air temp sensor. (6.7L, disconnect MAF sensor). Lift up and pull OE air box out of vehicle.

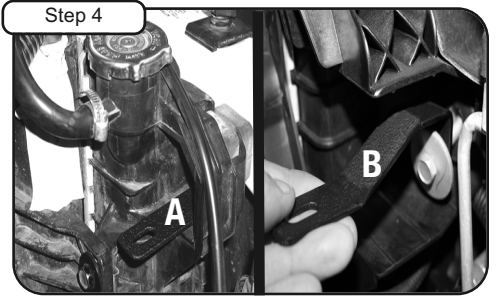

Step 4
With 10mm socket, loosen bolt holding in radiator housing, install bracket "D" and re-tighten bolt. Figure A shows 03-09 location. Figure B is the 2010 brackets location.



Step 5
Install 3/4" Trim seal to housing. Now install housing into vehicle.

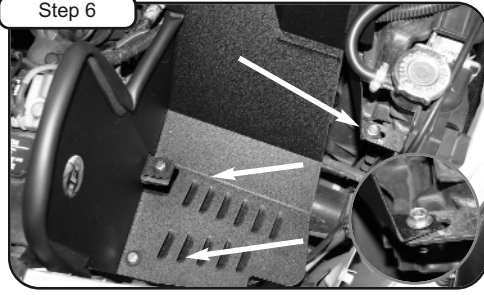

Step 6
With 3/8" screws/nuts and washers provided install bottom of housing to factory position. Tighten using 9/16" wrench or socket. Use M6 screw/nut and washer and tighten housing to bracket "D" and tighten.



Step 7
With T-20 torx bit remove temp sensor and (with gasket and screws provided) install into new tube. (5.9L place MAF cover with gasket and tighten using short screws provided. Install plug into the hole in tube for crank case line.)

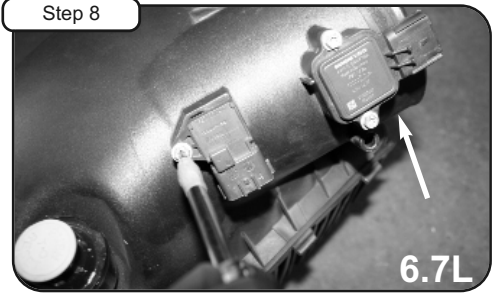

Step 8
(6.7L remove and install temp sensor, see step 7) 6.7L, remove MAF sensor and install to new tube with screws and gasket (Make sure gasket is between sensor and tube) Install grommet only to tube. The 6.7L will not use small phillips screws.



Step 9
Install hi-temp coupler with clamps provided to tube. Now install tube into vehicle.

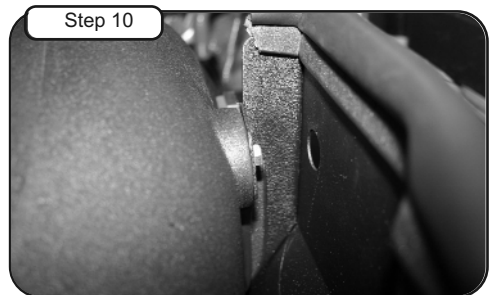

Step 10
Place tube on top of housing. Install M6 screw and washer through housing to tube. Do not tighten!

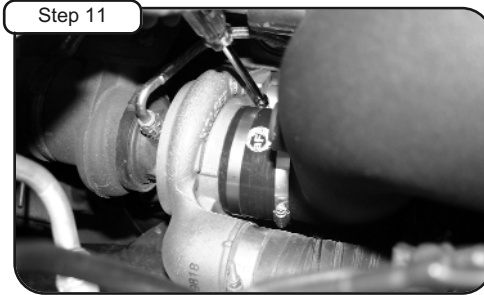

Step 11
Tighten clamps using 5/16" nut driver. (6.7L, install OE crank case line from step 2 in to new tube using rubber grommet)

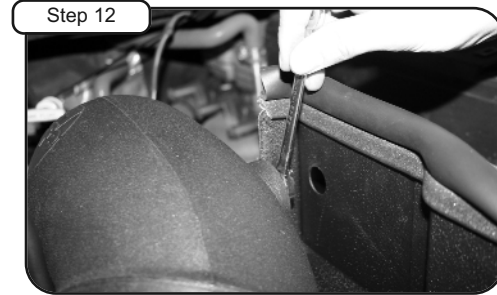

Step 12
Now tighten screw using 10mm socket or wrench.

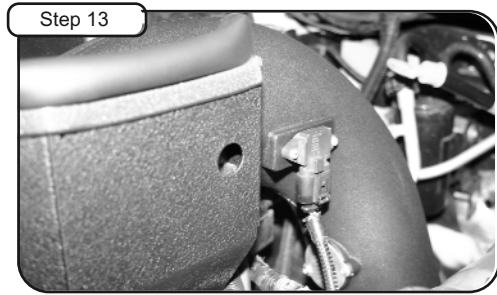

Step 13
Reconnect all sensor harnesses.



Step 14
Install air filter and tighten using 5/16" nut driver.



advanced FLOW engineering
252 Granite St.
Corona, CA 92878
Support: 951-493-7100
aFepower.com

Intake kit Installation Instructions: 2003-2009 Dodge Ram 2500-3500 Cummins (td) Stage-2 Air Intake

Kit P/N: 51/54/75-11342-1	Tools Required: 11mm socket or wrench 10mm socket or wrench 5/16" nut driver 1/4" nut driver Flat head screwdriver Ratchet w/ extension T-20 torx bit (included) Pliers/cutters	Parts list: 1 Air filter (P/N <i>Pro SR</i> ™ 24-91046 <i>ProDry-5</i> ™ 21-91046 or <i>Pro-GUARD 7</i> ™ 72-91046)(Step14) 1 Housing, wrinkle black(Step5) 1 Tube(Step7) 1 Coupler, straight hi-temp 4" x 2-1/2"(Step9) 1 3/4" trim seal @ 27.5"L(Step5) 1 3/4" trim seal @ 13.5"L(Step5) 2 Clamp, #064(Step5) 1 Torx bit, T-20(Step7) 1 Screw, hex M6 x 1 x 12(Step12) 1 Screw, hex M6 x 1 x 20(Step6) 3 Washer, flat(Step6&12)	1 Nut, hex M6(Step6) 1 Gasket, MAF sensor(Step7) 1 Gasket, temp sensor(Step7) 1 Bracket, "D" (Use only on 2003-2009)(Step4) 1 Bracket, 05-01114 (Use only on 2010)(Step4) 1 Plate, MAF sensor (for use of 5.9L)(Step7) 1 Grommet, rubber (for use of 5.9L)(Step7) 1 Plug, 05-01068 (for use of 5.9L)(Step7) 2 Screws, phillips #8-32 x 5/16"(Step7) 3 Screws, slotted #8-32 x 5/8"(Step8) 2 Screw, hex 3/8-16 x 1-1/2" (Step6) 2 Locknut, hex 3/8-16(Step6) 4 Washer, flat 3/8" x 7/8"OD(Step6)	1 Washers, lock M6(Step6)
----------------------------------	----------------------------------------------------------------------------------------------------------------------------------------------------------------------------------------------------------------	---------------------------------------------------------------------------------------------------------------------------------------------------------------------------------------------------------------------------------------------------------------------------------------------------------------------------------------------------------------------------------------------------------------------------------------------------------------------------	-------------------------------------------------------------------------------------------------------------------------------------------------------------------------------------------------------------------------------------------------------------------------------------------------------------------------------------------------------------------------------------------------------------------------------------------------------------------------------------------------------------------------------------	---------------------------

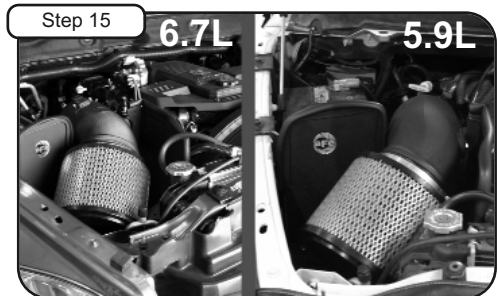

Place the included CARB EO Sticker on or near the intake system on a smooth, clean surface. E.O. identification label is required in passing the Smog Check Inspection. Reconnect negative battery cables. Your installation is now complete. Please check all bolts and clamps periodically. Re-tighten if necessary. Thank you for choosing aFe!

Note: Filter Cleaning and Re-oiling: When cleaning your aFe filter, be sure to use only aFe's "Restore Kit" (aFe P/N: 90-50000 gold oil aerosol, aFe P/N: 90-50500 gold squeeze oil, aFe P/N: 90-50001 blue oil aerosol, aFe P/N: 90-50501 blue squeeze oil, or aFe P/N: 90-59999 dry restore kit).
Filter Replacement: Magnum FLOW PN: 72-91046 *Pro-GUARD 7*™ (black w/gold media), *Pro SR*™ P/N: 24-91046 (black w/ blue media) or *Pro Dry 5*™ P/N: 21-91046 (black w/white media) *Pro Dry 5*™ cleaning: see cleaning instruction sheet 06-00074