

1987-1993 FORD MUSTANG GT - 8CYL 5.0L

NOTE: MAGNAFLOW Performance exhaust systems are designed for a correct fit on vehicles with OEM components. Aftermarket accessories such as headers, and/or cross-over assemblies (H-Pipe / X-Pipe) may not fit like the OEM components, and may require fabrication for proper fit of your MAGNAFLOW system.

Warning: When working on under or around any vehicle exercise caution. Please allow the vehicle's exhaust system to cool before removal, as exhaust system temperatures may cause severe burns. If working without a lift, always consult vehicle manual for correct lifting specifications. Always wear safety glasses and ensure safe work area. Serious injury or death could occur if safety measures are not followed.

Step 1: To begin removal of your OEM exhaust system, you will need to cut the tail-pipes just behind the mufflers. Remove the tail pipes from the OEM rubber insulators. Do not damage the OEM rubber insulators, as they will be re-used with your new system. Next unbolt the extension pipes from the H-pipe and remove the mufflers from their OEM rubber insulators. Do not discard the fasteners required to bolt the extension pipes to the mufflers, as they will be re-used.

Step 2: Remove the existing muffler mount brackets, and replace them with the new brackets supplied in the kit. Do not discard the OEM mount fasteners, as they will be re-used. Refer to diagram #2 for installation of the new muffler mounts.

Step 3: Starting at the H-pipe, begin installing your new exhaust system by bolting up the front extension pipes with the flanges supplied in the kit and the OEM fasteners. Leave all components loose until a final position has been set. Working rearward, install the mufflers, and tailpipes using the supplied clamps. Then install the polished tips using the supplied band clamps hangers and set-screws.

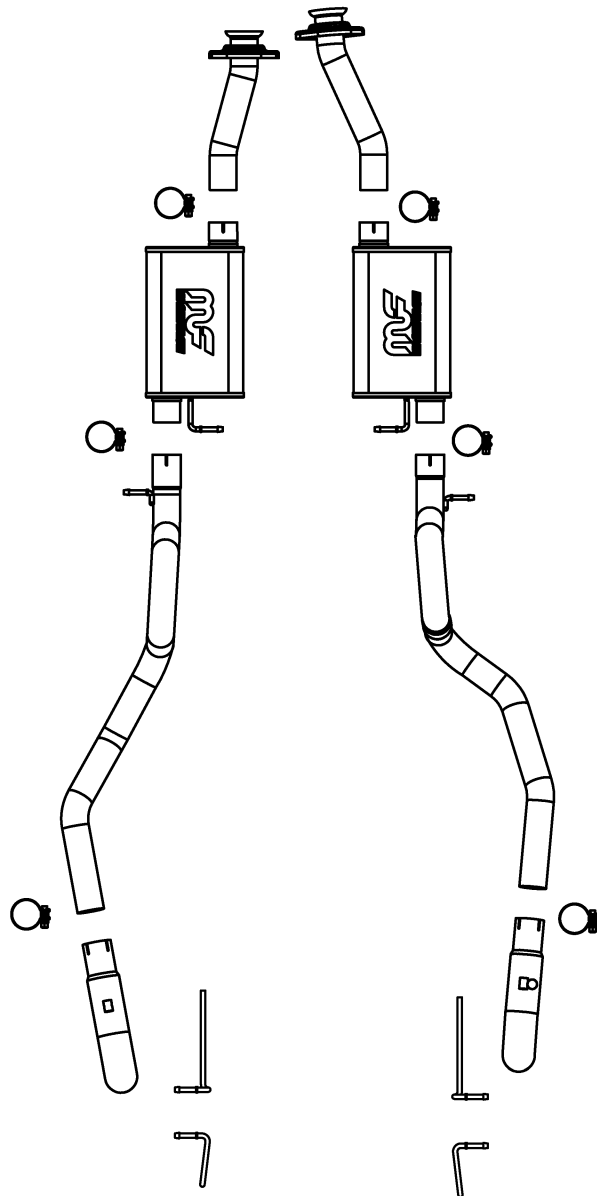

1987-1993 FORD MUSTANG GT - 8CYL, 5.0L

DIAGRAM 2

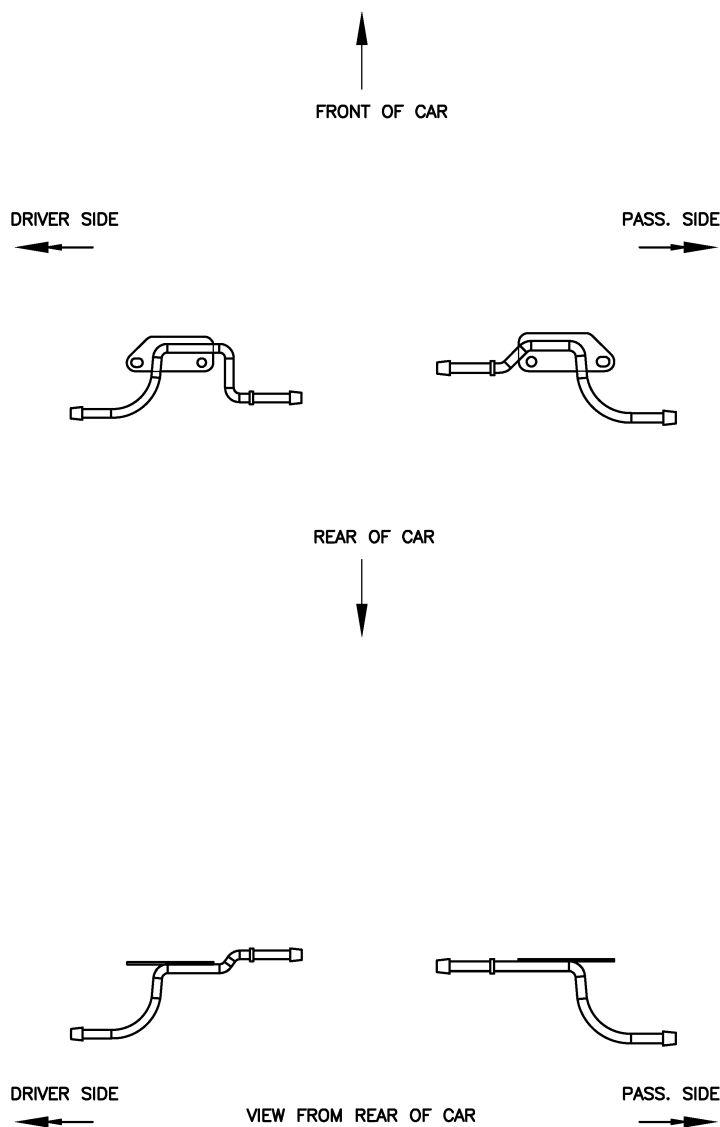

Warning: When working on under or around any vehicle exercise caution. Please allow the vehicle's exhaust system to cool before removal, as exhaust system temperatures may cause severe burns. If working without a lift, always consult vehicle manual for correct lifting specifications. Always wear safety glasses and ensure safe work area. Serious injury or death could occur if safety measures are not followed.

Step 4: Adjust all components for clearance of the frame, bodywork, and overall aesthetics. (MAGNAFLOW recommends at least 1/2" of clearance between the exhaust tips and the rear fascia to avoid heat related body damage or fire.) Once a final position has been chosen for the new system, evenly tighten all fasteners from front to rear. The supplied band clamps for the tips must be VERY tight to properly align the pipes and prevent leaks (Approximately 40ft-lbs). U-bolt clamps should be tightened to approximately 30-35ft-lbs. Inspect all fasteners after 25-50 miles of operation and retighten if necessary.

*MAGNAFLOW Performance Exhaust recommends professional installation on all their products

Technical support: 1-800-959-9226 ext. 4500